

- Chiave inclusa
- Key included
- Schluessel inbegriffen

| Cod. MT | Mandrino Spindle Spindel | I | RPM | Coppia Max Max Torque Max Drehmoment | Reversibile lato mandrino/contromandrino Reversible sub/main spindle side Umkehrbare Spindelseite/ Gegenspindelseite | Lubr.interna Coolant through Innenkuehlung | Lubr.esterna Ext. coolant Aussenkuehlung | A | A1 | B | D | L | CHIAVI NON INCLUDE Keys not included Schluessel nicht inbegriffen | | |
|-------------|--------------------------|-----|------|--------------------------------------|--|--|--|-------|------|----|----|----|---|----------------|------------|
| DW 00700125 | ER25 | 1:1 | 6000 | 100Nm | X | - | X | 91.16 | - | 54 | - | - | - | CHSTER25 | OKU0650004 |
| DW 00700225 | ER25 | 1:1 | 6000 | 100Nm | X | P=70bar | X | 91.16 | - | 65 | - | - | - | CHSTER25 | OKU0650004 |
| DW 00700132 | ER32 | 1:1 | 6000 | 100Nm | X | - | X | 93.66 | - | 54 | - | - | - | CHSTER32 | OKU0650004 |
| DW 00700232 | ER32 | 1:1 | 6000 | 100Nm | X | P=70bar | X | 93.66 | - | 65 | - | - | - | CHSTER32 | OKU0650004 |
| DW 00700140 | ER40 | 1:1 | 6000 | 100Nm | X | - | X | 98.16 | - | 54 | - | - | - | CHSTER40 | OKU0650004 |
| DW 00700240 | ER40 | 1:1 | 6000 | 100Nm | X | P=70bar | X | 98.16 | - | 65 | - | - | - | CHSTER40 | OKU0650004 |
| DW 00700325 | ERA25 | 1:1 | 6000 | 100Nm | X | - | X | 65 | - | 54 | - | - | CHUB27 | CHTAER25ZC | OKU0650004 |
| DW 00700425 | ERA25 | 1:1 | 6000 | 100Nm | X | P=70bar | X | 65 | - | 65 | - | - | CHUB27 | CHTAER25ZC | OKU0650004 |
| DW 00700516 | Ø16x17 | 1:1 | 6000 | 100Nm | X | - | X | - | 67.5 | 54 | 16 | 17 | - | CH_VTCROCE_M08 | OKU0650004 |
| DW 00700522 | Ø22x19 | 1:1 | 6000 | 100Nm | X | - | X | - | 67.5 | 54 | 22 | 19 | - | CH_VTCROCE_M10 | OKU0650004 |
| DW 00700527 | Ø27x21 | 1:1 | 6000 | 100Nm | X | - | X | - | 70 | 54 | 27 | 21 | - | CH_VTCROCE_M12 | OKU0650004 |

HAAS

MOD: ST20/25/28/30/35 (BMT65) - DS30 (BMT65)

MODULO MOTORIZZATO ASSIALE H=72mm

Axial driven tool H=72mm

Axial angetriebenes Werkzeug H=72mm

Subject to change without notice.

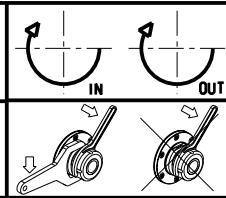

M.T. srl

Via Casino Albini 480
Tel. 0541/956034-957884

Fax 0541/956341

47842 S. GIOVANNI IN M. (RN)

e-mail: mtma@mtmarchetti.com

http://www.mtmarchetti.com



PAGINA HAS150-4-11

09/2023