

Cod. MT	Mandrino Spindle Spindel	I	RPM	Coppia Max Max Torque Max Drehmoment	Lubr.interna Coolant through Innenkuehlung	Lubr. esterna Ext. coolant Aussenkuehlung	A	CHIAVI NON INCLUDE Keys not included Schluessel nicht einbegriffen		
								C HUB36	OKU04 30007	CHTAER40ZC
DW 01992140	ERA40	2:1	3000	160Nm	-	X	7	C HUB36	OKU04 30007	CHTAER40ZC
DW 01994240	ERA40	2:1	3000	160Nm	P=70bar	X	18	C HUB36	OKU04 30007	CHTAER40ZC

- Chiave inclusa
- Key included
- Schluessel inbegriffen

DN SOLUTIONS (DOOSAN) BMT 75

MOD: PUMA 400 - PUMA 480M/LM/XLM - PUMA 4100M - PUMA 5100M/Y - V550M - VT 750M/TM - V8300M

MODULO MOTORIZZATO RADIALE RIDOTTO I=2:1 DISASSATO IN Z 100mm

Radial geared-down I=2:1 driven tool re-directed in Z by 100mm

Radial angetriebenes Werkzeug untersetzt I=2:1 achsversetzt in Z um 100mm

Subject to change without notice.

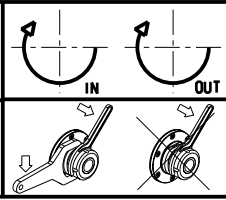

M.T. srl
 Via Casino Albini 480
 Tel. 0541/956034-957884
 Fax 0541/956341
 47842 S. GIOVANNI IN M. (RN)
 e-mail: mtma@mtmarchetti.com
 http://www.mtmarchetti.com



PAGINA DW 0030-4-20