

- Chiave inclusa
- Key included
- Schlüssel inbegriffen

Cod. MT	Mandrino Spindle Spindel	I	RPM	Coppia Max Max Torque Max Drehmoment	Lubrificazione int. Coolant through Innenkuehlung	Lubrificazione est. Exl. coolant Aussenkuehlung	CHIAVI NON INCLUSE Keys not included Schlüssel nicht einbegriffen	
SAU0880140	ERA40	1:1	4000	100Nm	-	X	CHUB42	OKU0430007 *
SAU0880240	ERA40	1:1	4000	100Nm	P=30bar	X	CHUB42	OKU0430007 *

SAUTER
VDI 50

MODULO MOTORIZZATO ASSIALE VDI50 DIN 5482
Axial driven tool VDI50 DIN 5482
Axial angetriebenes Werkzeug VDI50 DIN 5482

Subject to change without notice.

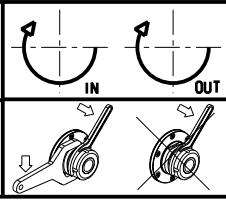

M.T. srl
Via Casino Albini 480
Tel. 0541/956034-957884
Fax 0541/956341
47842 S. GIOVANNI IN M. (RN)
e-mail: mtma@mtmarchetti.com
http://www.mtmarchetti.com



PAGINA SAU014-4-00