

ATTENZIONE - ATTENTION - ACHTUNG

- Per lo smontaggio degli utensili utilizzare sempre la chiave di contrasto come indicato nel manuale d'uso.
- For disassembly of the tools use always the contrast key as mentioned in the user instructions.
- Fuer das Abmontieren der Werkzeuge immer den Gegenschlüssel benutzen wie in der Bedienungsanleitung erwaeht.

- Chiave inclusa
- Key included
- Schlüessel inbegriffen

Cod. MT	Mandrino Spindle Spindel	I	RPM	Coppia Max Max Torque Max Drehmoment	Reversibile lato mandrino/contromandrino Reversible sub/main spindle side Umkehrbare Spindelseite/ Gegenspindelsteite	Lubr.esterna Ext. coolant Aussenkuehlung	CHIAVI NON INCLUDE Keys not included Schlüssel nicht einbegriffen	
OKU1660232	ERA32+ERA32	1:1	6000	70Nm	X	X	CHUB30	CHTAER32ZC • OKU0650004 •

OKUMA
 MOD: MULTUS U3000/4000/5000 2SW - GENOS L300MW /MYW
 MODULO MOTORIZZATO ASSIALE BISPORGENTE H=90mm
 Axial opposite face twin driven tool H=90mm
 Axial angetriebenes Werkzeug halb vorspringend H=90mm

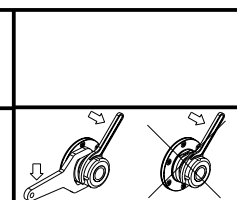

M.T. srl
 Via Casino Albini 480
 Tel. 0541/956034-957884
 Fax 0541/956341
 47842 S. GIOVANNI IN M. (RN)
 e-mail: mtma@mtmarchetti.com
 http://www.mtmarchetti.com



PAGINA OKU240-4-20

Subject to change without notice.

09/2023