

**TORRETTE RADIALI
RADIAL TURRETS
RADIAL REVOLVER**

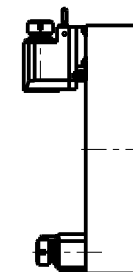

**TORRETTE ASSIALI
AXIAL TURRETS
AXIAL REVOLVER**



- Chiave inclusa
- Key included
- Schlüssel inbegriffen

| Cod. MT | Mandrino Spindle Spindel | I | RPM | Coppia Max Max Torque Max Drehmoment | Lubrificazione int. Coolant through Innenkuehlung | Lubrificazione est. Ext. coolant Aussenkuehlung | A | B | CHIAVI NON INCLUSE Keys not included Schluessel nicht einbegriffen | | |
|------------|--------------------------|-----|------|--------------------------------------|---|---|-------|------|--|------------|------------|
| OKU1120120 | ER20 | 1:1 | 6000 | 32Nm | - | X | 41.16 | 73.5 | - | CHSTER20 | OKU0290009 |
| OKU1120220 | ER20 | 1:1 | 6000 | 32Nm | P=70bar | X | 41.16 | 83.5 | - | CHSTER20 | OKU0290009 |
| OKU1120320 | ERA20 | 1:1 | 6000 | 32Nm | - | X | 24.5 | 73.5 | CHUB22 | CHTAER20ZC | OKU0290009 |
| OKU1120420 | ERA20 | 1:1 | 6000 | 32Nm | P=70bar | X | 24.5 | 83.5 | CHUB22 | CHTAER20ZC | OKU0290009 |
| OKU1120125 | ER25 | 1:1 | 6000 | 32Nm | - | X | 42.16 | 73.5 | - | CHSTER25 | OKU0290009 |
| OKU1120225 | ER25 | 1:1 | 6000 | 32Nm | P=70bar | X | 42.16 | 83.5 | - | CHSTER25 | OKU0290009 |
| OKU1120325 | ERA25 | 1:1 | 6000 | 32Nm | - | X | 28.5 | 73.5 | CHUB27 | CHTAER25ZC | OKU0290009 |
| OKU1120425 | ERA25 | 1:1 | 6000 | 32Nm | P=70bar | X | 28.5 | 83.5 | CHUB27 | CHTAER25ZC | OKU0290009 |

OKUMA
MOD: LB200 - GENOS L200M - GENOS L2000e M/MY - ES L6 M - ES L8II M - LB10M - LR10M - LU200M

MODULO MOTORIZZATO RADIALE ARRETRATO VD130
Radial rear-set driven tool VD130
Radial angetriebenes Werkzeug zurueckversetzt VD130

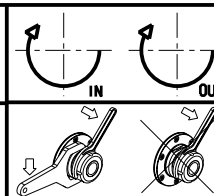

M.T. srl
Via Casino Albini 480
Tel. 0541/956034-957884
Fax 0541/956341
47842 S. GIOVANNI IN M. (RN)
e-mail: mtma@mtmarchetti.com
http://www.mtmarchetti.com



PAGINA OKU015-1-00

Subject to change without notice.

09/2023