

- Chiave inclusa
- Key included
- Schlüssel inbegriffen

Cod. MT	Mandrino Spindle Spindel	I	RPM	Coppia Max Max Torque Max Drehmoment	Reversibile lato mandrino/controlmandrino Reversible sub/main spindle side Umkehrbare Spindel-seite/Gegenspindel-seite	Lubrificazione int. Coolant through Innenkuehlung	Lubrificazione est. Ext. coolant Aussenkuehlung	A	A1	B	D	L	CHIAVI NON INCLUDE Keys not included Schluessel nicht inbegriffen		
													Key	Key	
MYA0110125	ER25	1:1	6000	40Nm	X	-	X	91.2	-	49	-	-	-	CHSTER25	OKU0290009 •
MYA0110225	ER25	1:1	6000	40Nm	X	P=70bar	X	91.2	-	60	-	-	-	CHSTER25	OKU0290009 •
MYA0110325	ERA25	1:1	6000	40Nm	X	-	X	72.5	-	49	-	-	CHUB27	CHTAER25ZC •	OKU0290009 •
MYA0110425	ERA25	1:1	6000	40Nm	X	P=70bar	X	72.5	-	60	-	-	CHUB27	CHTAER25ZC •	OKU0290009 •
MYA0110522	Ø22x19	1:1	6000	40Nm	X	-	X	-	70	49	22	19	-	CH_VTCROCE_M10 •	OKU0290009 •

MIYANO

MOD: ABX-51/64 SY/TH2/TH3 - BND-51 C/S/SY - BNE-34/51 S/SY/MSY - BNJ-34/42/51 S/SY - BNX-42/51 SY

MODULO MOTORIZZATO ASSIALE H=65mm

Axial driven tool H=65mm

Axial angetriebenes Werkzeug H=65mm

Subject to change without notice.

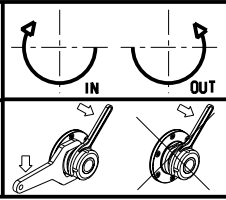

M.T. srl
 Via Casino Albini 480
 Tel. 0541/956034-957884
 Fax 0541/956341
 47842 S. GIOVANNI IN M. (RN)
 e-mail: mtma@tmarchetti.com
 http://www.tmmarchetti.com



PAGINA MYA150-2-10