

PER PORTAUTENSILI MODULARI MTSK-63 VEDI PAG. TBL300-1-63
 FOR MTSK-63 QUICK CHANGE TOOLHOLDERS CLAMPINGS SEE PAGE TBL300-1-63
 FUER MTSK-63 MODULARE WERKZEUGAUFNAHMEN SIEHE SEITE TBL300-1-63

| Cod. MT | Mandrino Spindle Spindel | I | RPM | Coppia Max Max Torque Max Drehmoment | Reversibile lato mandrino/contromandrino Reversible sub/main spindle side Umkehrbare Spindel-seite/ Gegenspindel-seite | Lubrificazione int. Coolant through Innenkuhlung | Lubrificazione est. Ext. coolant Aussenkuhlung | B | CHIAVI NON INCLUSE Keys not included Schlüssel nicht einbegriffen | |
|------------|--------------------------|-----|------|--------------------------------------|--|--|--|------|---|--------------|
| DW01200163 | MTSK-63 | 2:1 | 1500 | 300Nm | X | | X | 65.5 | CHUB68 | NZL0010023 • |
| DW01200263 | MTSK-63 | 2:1 | 1500 | 300Nm | X | P=70bar | X | 82 | CHUB68 | NZL0010023 • |

- Chiave inclusa
- Key included
- Schlüssel inbegriffen

HW ACHEON
 VT950/1150 - HI-TECH 750 - HI-TECH 850

MODULO MOTORIZZATO ASSIALE MTSK RIDOTTO I=2:1 H=110mm
 Axial MTSK geared-down I=2:1 driven tool H=110mm
 Axial MTSK angetriebenes Werkzeug untersetzt I=2:1 H=110mm

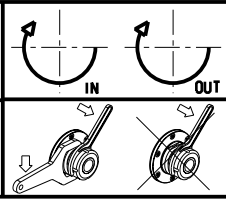

M.T. srl
 Via Casino Albini 480
 Tel. 0541/956034-957884
 Fax 0541/956341
 47842 S. GIOVANNI IN M. (RN)
 e-mail: mtma@mtmarchetti.com
 http://www.mtmarchetti.com



PAGINA HWC190-4-20-K

Subject to change without notice.

09/2023