

- Chiave inclusa
- Key included
- Schluessel inbegriffen

| Cod. MT | Mandrino Spindle Spindel | I | RPM | Coppia Max Max Torque Max Drehmoment | Lubrificazione int. Coolant through Innenkuehlung | Lubrificazione est. Ext. coolant Aussenkuehlung | A | CHIAVI NON INCLUSE Keys not included Schluessel nicht inbegriffen | | |
|-------------|--------------------------|-----|------|--------------------------------------|---|---|----|---|------------|------------|
| DW 02000325 | ERA25 | 1:1 | 6000 | 35Nm | - | X | 52 | CHUB27 | CHTAER25ZC | OKU0290009 |
| DW 03520425 | ERA25 | 1:1 | 6000 | 35Nm | P=70bar | X | 56 | CHUB27 | CHTAER25ZC | OKU0290009 |

HAAS
 MOD: ST10/15Y (BMT45)
 MODULO MOTORIZZATO RADIALE
 Radial driven tool
 Radial angetriebenes Werkzeug

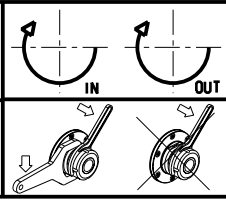

M.T. srl
 Via Casino Albini 480
 Tel. 0541/956034-957884
 Fax 0541/956341
 47842 S. GIOVANNI IN M. (RN)
 e-mail: mtma@mtmarchetti.com
 http://www.mtmarchetti.com



PAGINA HAS010-5-01

Subject to change without notice.