

- Chiave inclusa
- Key included
- Schluessel inbegriffen

Cod. MT	Cod. MORI-SEIKI	Mandrino Spindel Spindel	I	RPM	Coppia Max Max Torque Max Drehmoment	Lubrificazione int. Coolant through Innenkuehlung	Lubrificazione est. Ext. coolant Aussenkuehlung	A	A1	A2	D	L	CHIAVI NON INCLUDE Keys not included Schluessel nicht einbegriffen	
MNZ0020120	T32254	ER20	1:1	6000	40Nm	-	X	72.16	-	-	-	-	MNZ0410005	CHSTER20
MNZ0020125	T32274	ER25	1:1	6000	40Nm	-	X	73.16	-	-	-	-	MNZ0410005	CHSTER25
MNZ0021225	-	ER25	1:1	6000	40Nm	P=70bar	X	83.66	-	-	-	-	MNZ0410005	CHSTER25
MNZ0020132	-	ER32	1:1	6000	40Nm	-	X	76.16	-	-	-	-	MNZ0410005	CHSTER32
MNZ0021232	-	ER32	1:1	6000	40Nm	P=70bar	X	86.66	-	-	-	-	MNZ0410005	CHSTER32
MNZ0020416	-	Ø16x17	1:1	6000	40Nm	-	X	-	54.5	-	16	17	MNZ0410005	CH_VTCROCE_M08
MNZ0020422	-	Ø22x19	1:1	6000	40Nm	-	X	-	54.5	-	22	19	MNZ0410005	CH_VTCROCE_M10
MNZ0020419	-	Ø3/4"x3/4"	1:1	6000	40Nm	-	X	-	54.5	-	3/4"	3/4"	MNZ0410005	CH_VTCROCE_M08
MNZ0020308	-	WELDON 8	1:1	6000	40Nm	-	X	-	-	72.5	-	-	-	-
MNZ0020310	-	WELDON 10	1:1	6000	40Nm	-	X	-	-	74.5	-	-	-	-
MNZ0020312	-	WELDON 12	1:1	6000	40Nm	-	X	-	-	77	-	-	-	-
MNZ0020316	-	WELDON 16	1:1	6000	40Nm	-	X	-	-	79.5	-	-	-	-

DMG-MORI

NZ1500/2000 - NZX1500/2000 - NZX2500 (BMT40) - NT3100/3150/3200 - NL1500/2000/2500 20 STAZ. - NLX1500/2000/2500 20 STAZ. - NT1000/2000 - NTX500 (BMT40)
 NTX1000/2000 - NTX1000/2000/2500/3000 2ND GEN. 12ST. - DURATURN 2050MC/2550MC - NRX2000 - ALX1500/2000/2500 - ECOTURN 450 (BMT40) - NZ DUE/TRE/QUATTRO (BMT40)

MODULO MOTORIZZATO RADIALE
 Radial driven tool
 Radial angetriebenes Werkzeug

Subject to change without notice.

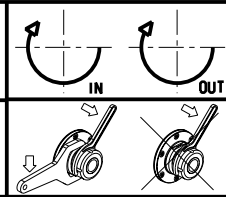

M.T. srl

Via Casino Albini 480
 Tel. 0541/956034-957884
 Fax 0541/956341
 47842 S. GIOVANNI IN M. (RN)
 e-mail: mtma@mtmarchetti.com
 http://www.mtmarchetti.com



PAGINA MNZ010-1-00