

ATTENZIONE - ATTENTION - ACHTUNG

- VERIFICARE LE MISURE DI INGOMBRO PER POSSIBILE INTERFERENZA SU ALCUNI MODELLI DI MACCHINE
- Please check the overall sizes for possible interferences on some machine models
- Bitte überprüfen sie das ausmass um mögliche interenzen auf einigen maschinen modellen zu vermeiden

- Chiave inclusa
- Key included
- Schluessel inbegriffen

| Cod. MT | Mandrino Spindle Spindel | I | RPM | Coppia Max Max Torque Max Drehmoment | Reversibile lato mandrino/contromandrino Reversible sub/main spindle side Umkehrbare Spindel-seite/ Gegenspindel-seite | Lubrificazione int. Coolant through Innenkuehlung | Lubrificazione est. Ext. coolant Aussenkuehlung | A | B | CHIAVI NON INCLUSE Keys not included Schluessel nicht inbegriffen | | |
|-------------|--------------------------|-----|------|--------------------------------------|--|---|---|------|----|---|------------|------------|
| DW 04040320 | ERA20 | 1:1 | 6000 | 35Nm | X | - | X | 66,5 | 46 | CHUB22 | CHTAER20ZC | OKU0290009 |
| DW 04040420 | ERA20 | 1:1 | 6000 | 35Nm | X | P=70bar | X | 66,5 | 56 | CHUB22 | CHTAER20ZC | OKU0290009 |
| DW 04040325 | ERA25 | 1:1 | 6000 | 35Nm | X | - | X | 70 | 46 | CHUB27 | CHTAER25ZC | OKU0290009 |
| DW 04040425 | ERA25 | 1:1 | 6000 | 35Nm | X | P=70bar | X | 70 | 56 | CHUB27 | CHTAER25ZC | OKU0290009 |

DN SOLUTIONS (DOOSAN) BMT 45

MOD: LYNX 220 LMS/LY/LSY - LYNX 2100 M/LM/LMS/LY/LSY - LYNX 2105LY - PUMA MX1600 16ST.

MODULO MOTORIZZATO ASSIALE H=85mm

Axial driven tool H=85mm

Axial angetriebenes Werkzeug H=85mm

Subject to change without notice.

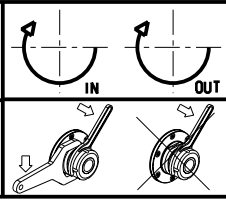

M.T. srl
Via Casino Albini 480
Tel. 0541/956034-957884
Fax 0541/956341
47842 S. GIOVANNI IN M. (RN)
e-mail: mtma@mtmarchetti.com
http://www.mtmarchetti.com



PAGINA DW 0150-1-10